

*** Do not display the fixed pattern for a long time when using a normally black panel, as it may cause image sticking due to the LCM structure. If the screen is displayed in fixed mode, use a screen saver. It is recommended to display the fixed mode in less than 2 minutes or less.

IMO	MPU Interface Mode	
0	RGB +9b_SPI (fall)	*Note1: 24-bit/pixel, Use DB[0:7], DG[0:7], DR[0:7]
1	RGB +16b_SPI (rise)	*Note2: 18-bit/pixel, Use DB[0:5], DG[0:5], DR[0:5]. Fix to GND when not in use.
		*Note3: 16-bit/pixel, Use DB[0:4], DG[0:5], DR[0:4]. Fix to GND when not in use.

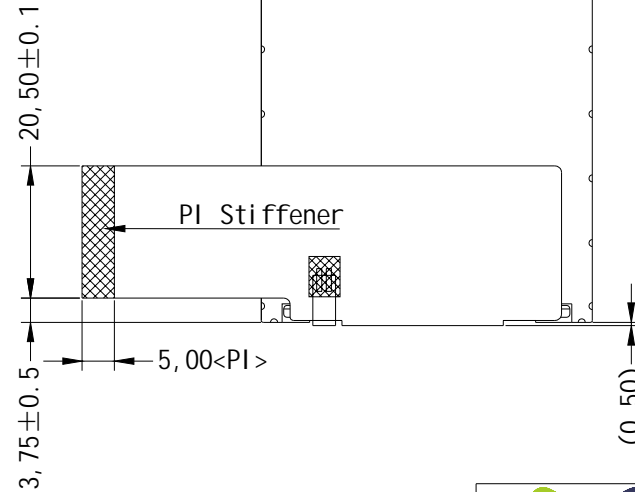
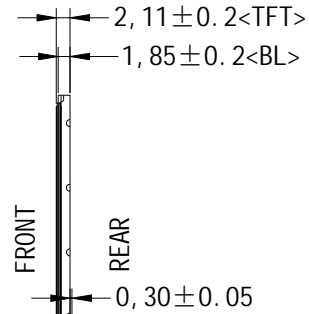
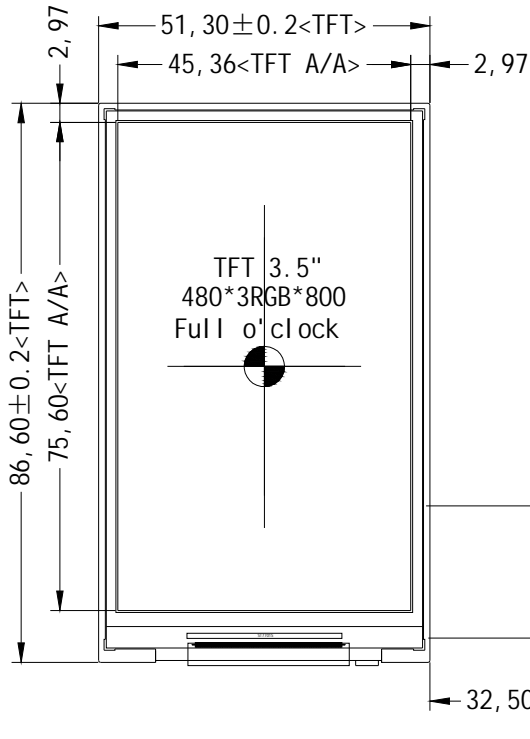

PIN_SIGNAL		PIN_SIGNAL	
1	LED_K	21	DB0
2	LED_A	22	DB1
3	GND	23	DB2
4	VCI	24	DB3
5	DR0	25	DB4
6	DR1	26	DB5
7	DR2	27	DB6
8	DR3	28	DB7
9	DR4	29	GND
10	DR5	30	PCLK
11	DR6	31	NC
12	DR7	32	HSD
13	DG0	33	VSD
14	DG1	34	DEN
15	DG2	35	IMO
16	DG3	36	GND
17	DG4	37	RESX
18	DG5	38	SPI_CS
19	DG6	39	SPI_SCL
20	DG7	40	SPI_SDA

*1. LCD Display Type	TFT/Transmissive/Normally Black/16.7M Color		
*2. Viewing Direction	Full View(U80/D80/R80/L80)	*6. Storage Temp	-30° C-80° C
*3. Interface	RGB +9b_SPI (fall)/16b_SPI (rise)	*7. Driver IC	ST7701S或者兼容IC
*4. Operating Voltage	IOVCC=1.8V, VCI=3.3V<TFT>	*8. Backlight	WHITE Vf= 21.0V If= 20mA(Typ)
*5. Operating Temp	-20° C-60° C	*9. LCM Brightness	350或550 cd/m ² (Typ)

屏状态	亮度cd/m ²
普通屏	350±75
高亮屏	550±75

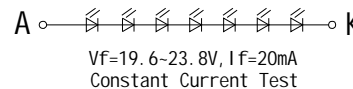

Dwg Title: TFT-H035A7WVI ST3N40			
Scale: 1:1	Unit: MM	Tol: ±0.3	
Ver: V0	Drawn: Liu.YL	Date: 2021-02-26	